

# FOR LEASE

# 2,323 Sq. Ft.

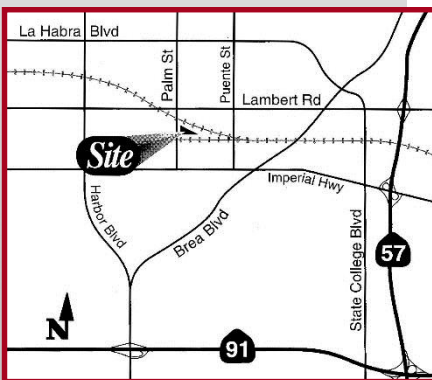

## 320 N. Palm Street, Ste. C, Brea Palm Commerce Centre



### Features Include:

- 610 Sq. Ft. Office Space
- Reception & 2 Private Offices
- 100 Amp 3-Phase Power – 120/208 Volt
- One 12'x12' Ground Level Loading Door
- 14' Warehouse Clearance
- Fire Sprinklers
- **HUGE Drive Between Buildings**
- **GREAT TRUCK ACCESS**
- High Image Project



**1241 N. Lakeview Avenue, Ste. F**  
**Anaheim, CA 92807**  
BRE #01033833  
[www.prpropertiesinc.com](http://www.prpropertiesinc.com)

**For Further Information Please Contact:**

**JIM POTTER | BRIAN DALTON**

BRE #00549334

BRE #01181724

**(714)777-1468 Fax (714)777-5779**

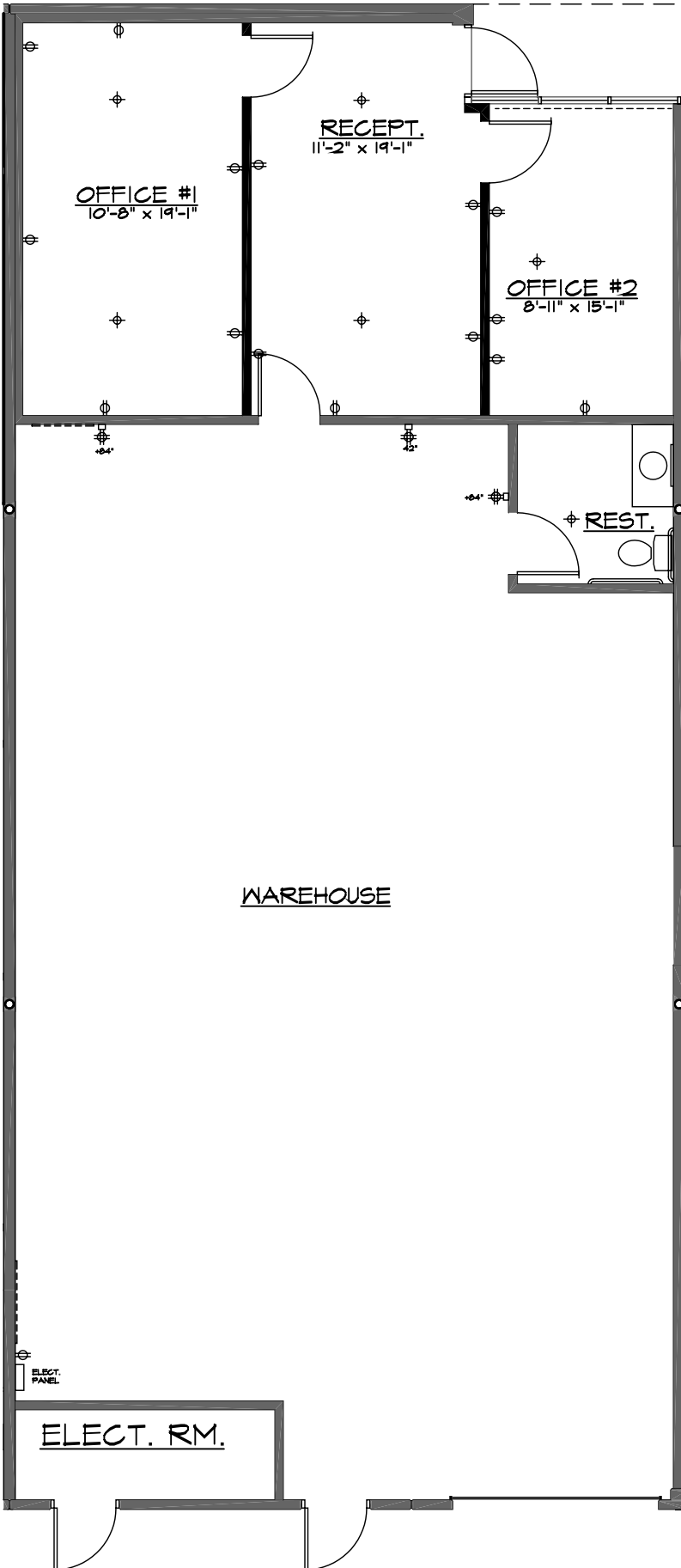

PALM COMMERCE CENTRE  
320 N. PALM ST. SUITE C  
BREA, CA

OFFICE SPACE: 610 SQ. FT.  
TOTAL SPACE: 2323 SQ. FT.

SCALE: 1/8" = 1'