

FOR LEASE

7,200 Sq. Ft. Major Street Frontage



1251 W. Katella Avenue, Orange, CA

Features Include:

- 720 sq. ft. office space (reception and one office)
- Glass side entrance
- Approximate 1,000 sq. ft. fenced yard
- One (1) 12'x14' ground level loading door
- 400 amps – 240 volt 3-phase power (verify)
- Building signage and shared pole signage
- 3:1 Parking Ratio
- M1 and CR uses possible – verify with City of Orange
- Major street frontage
- Easy access to 57/22/5/91 freeways



1241 N. Lakeview Avenue, Ste. F
Anaheim, CA 92807

For Further Information, Please Contact:

BRIAN DALTON or JIM POTTER
(714)777-1468 Fax (714)777-5779
www.prpropertiesinc.com

1251 W. Katella Avenue
Orange, CA

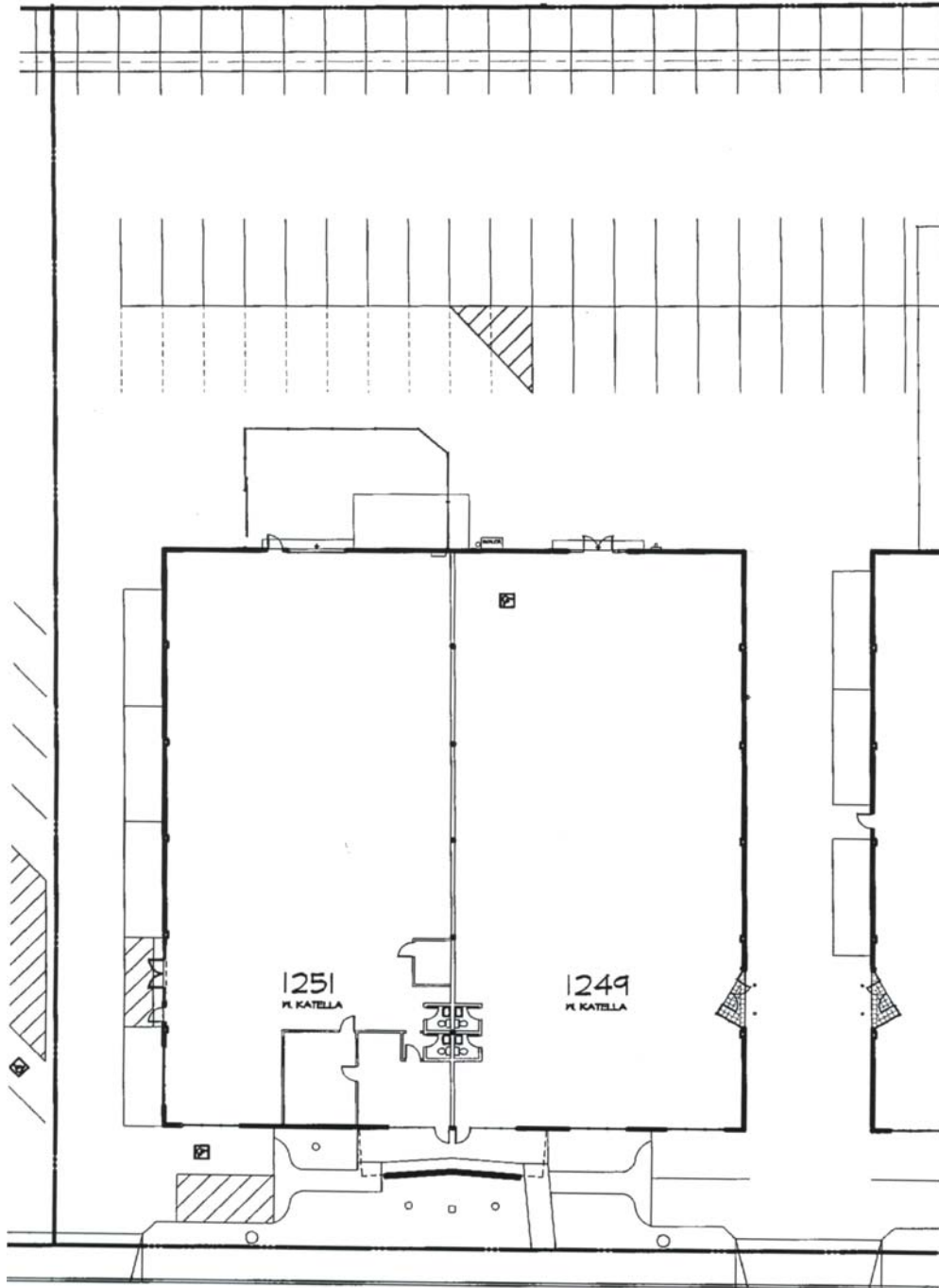

1241 N. Lakeview Avenue, Ste. F
Anaheim, CA 92807
DRE #01033833

For Further Information Please Contact:

JIM POTTER | BRIAN DALTON

DRE #00549334

DRE #01181724

(714)777-1468 Fax (714)777-5779