

FOR LEASE

28,600 Sq. Ft. RETAIL SPACE



1000 N. Tustin Ave., Anaheim, CA Tustin La Palma Center

Features Include:

- Expandable to 44,956 Sq. Ft. *(Depending on amount of parking needed.)*
- Approximately 4:1 Parking Ratio
- Fire Sprinklered
- +/- 10' Showroom T-Bar Ceiling *(Owner will remove t-bar ceiling.)*
- +/- 18' Clearance With T-Bar Removal
- 2 G/L Loading Doors (12'x14')
- 800 Amps - 480 volt /3 Phase *(verify)*
- Signage Visible From 91 Fwy & Tustin Ave.
- Monument Signage Available
- Zoned DA-3 (Transit-Oriented Area)
- Immediate Access to 91/57/55 Fwys
- Metrolink Anaheim Canyon Station Across Tustin Ave.
- New Apartments Approved Across Tustin Ave. *(verify status)*
- APN 346-132-12



1241 N. Lakeview Avenue, Ste. F
Anaheim, CA 92807
CA DRE #01033833

For Further Information Please Contact:

BRIAN DALTON or **JIM POTTER**

CA DRE #01181724

CA DRE #00549334

(714)777-1468 Fax (714)777-5779

**1000 N. Tustin Ave.
Anaheim, CA**

28,600 Sq. Ft.

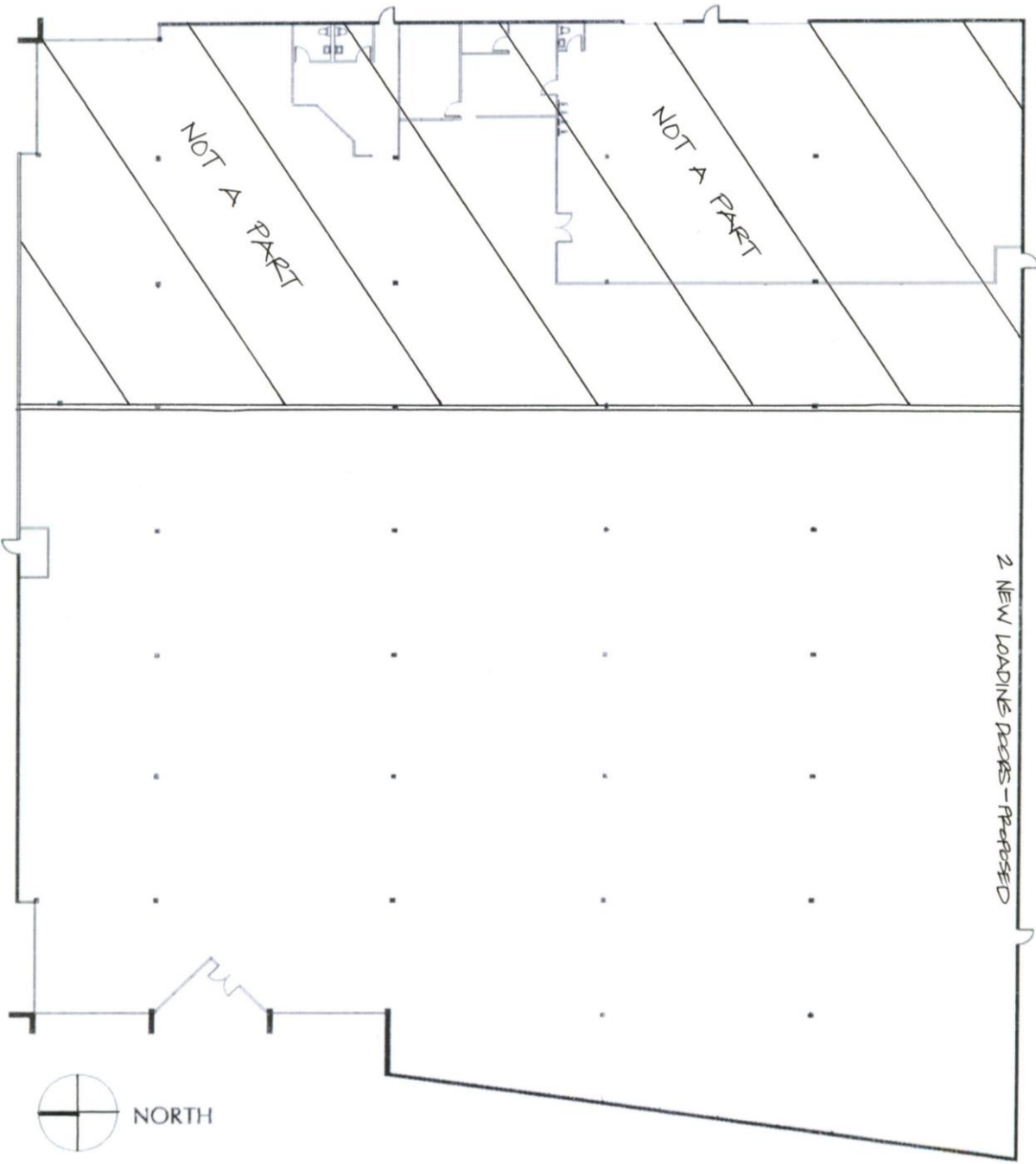

1241 N. Lakeview Avenue, Ste. F
Anaheim, CA 92807
CA DRE #01033833

For Further Information Please Contact:

BRIAN DALTON or **JIM POTTER**

CA DRE #01181724

CA DRE #00549334

(714)777-1468 Fax (714)777-5779

Information contained herein has been obtained by parties we deem reliable, however, we do not guarantee its accuracy and assume no liability. Do not rely on any of the information contained herein without verifying it yourself.

1000 N. Tustin Ave.
Anaheim, CA

28,600 Sq. Ft.

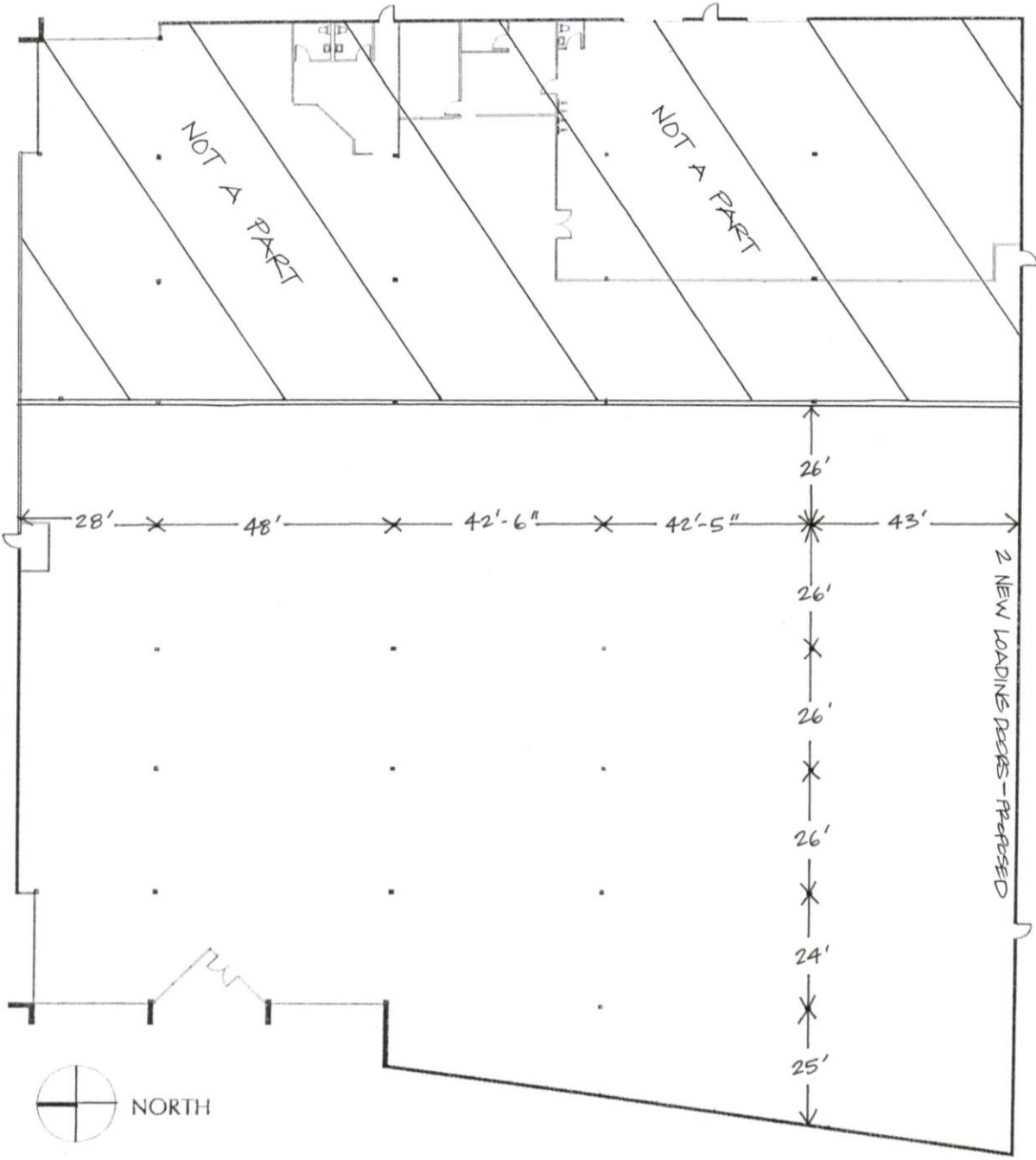

APPROXIMATE DIMENSIONS



1241 N. Lakeview Avenue, Ste. F
Anaheim, CA 92807
CA DRE #01033833

For Further Information Please Contact:

BRIAN DALTON or **JIM POTTER**

CA DRE #01181724

CA DRE #00549334

(714)777-1468 Fax (714)777-5779

Information contained herein has been obtained by parties we deem reliable, however, we do not guarantee its accuracy and assume no liability. Do not rely on any of the information contained herein without verifying it yourself.

**1000 N. Tustin Ave.
Anaheim, CA**



1241 N. Lakeview Avenue, Ste. F
Anaheim, CA 92807
CA DRE #01033833

For Further Information Please Contact:

BRIAN DALTON or **JIM POTTER**

CA DRE #01181724

CA DRE #00549334

(714)777-1468 Fax (714)777-5779